



*Our Focus is in Plastics*

**Polymer Optics Ltd.**

6 Kiln Ride, Wokingham,  
Berks., RG40 3JL, England  
Tel/Fax: +44 (0) 1189 893341  
www.polymer-optics.co.uk

### 15 Degree LED Collimator Lens - Part No. 201



- Designed for Edison Edixeon Emitter and Star LEDs
- High light collection efficiency of >85%
- Precision moulded in optical grade Polycarbonate for thermal stability and system durability
- Part of the Polymer Optics “Modular LED Optics”® range

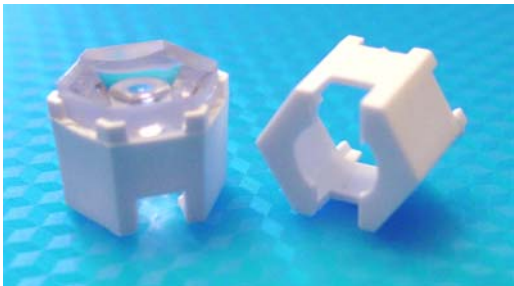

Typical dimensional tolerances  
to +/-0.2mm

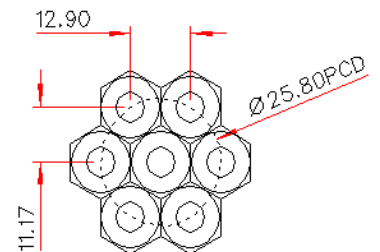
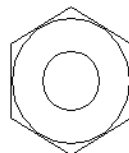

NESTED COMPONENTS ON 25,8MM PCD

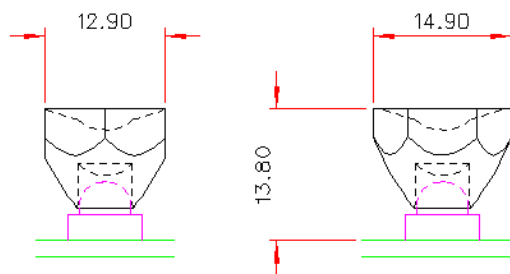

Polymer Optics “Modular LED Optics”® design, based on a hexagonal format, allows maximum packing density and assembly flexibility

Supplied assembled in Holder (Part No. 121) for mounting the optic directly onto the Edixeon LED package.



*Our Focus is in Plastics*

**Polymer Optics Ltd.**

6 Kiln Ride, Wokingham,  
Berks., RG40 3JL, England  
Tel/Fax: +44 (0) 1189 893341  
[www.polymer-optics.co.uk](http://www.polymer-optics.co.uk)

**15 Degree LED Collimator Lens - Part No. 201**

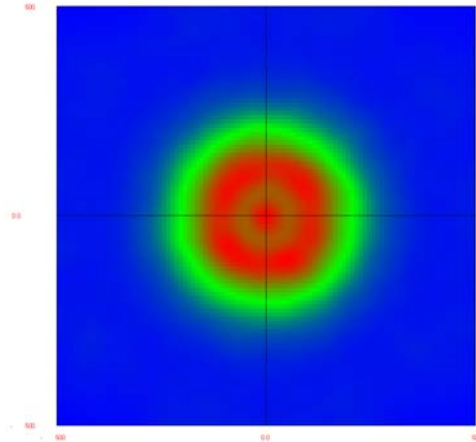

Raytrace Simulation of Typical Beam at 1m with 1W White LED

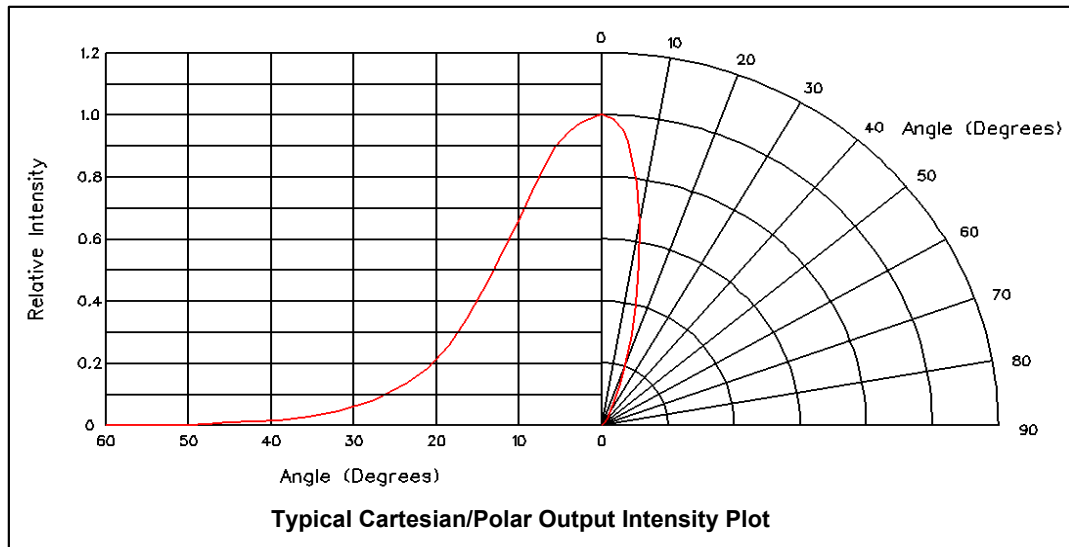

Typical illuminance values using 1W 25 lumen white LED = 9.6 cd/lumen			
Range	0.5m	1m	2m
Illuminance	960 lux	240 lux	60 lux

Performance values given are typical values and will vary dependant on LED binning, colour and drive profile