



**Polymer
Optics
Limited**

Our Focus is in Plastics

Polymer Optics Ltd.

6 Kiln Ride, Wokingham,
Berks., RG40 3JL, England
Tel/Fax: +44 (0) 1189 893341
www.polymer-optics.co.uk

Diffuse +/-25 Degree (50 Deg) LED Collimator Lens - Part No. 217



- Designed for LUXEON® I, III and K2 LEDs
- High light collection efficiency of >85%
- Diffuse output surface for improved beam uniformity
- Suitable for all LUXEON® “Lambertian” and “Bat-wing” LED designs
- Precision moulded in optical grade Polycarbonate for thermal stability and system durability
- Part of the Polymer Optics “Modular LED Optics”® range

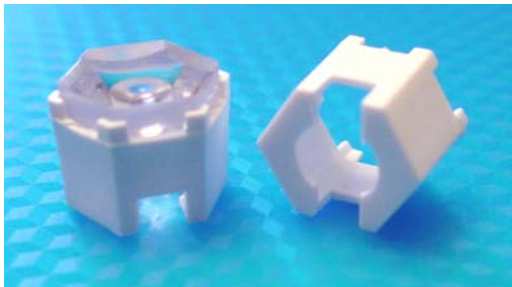

Typical dimensional tolerances to +/-0.2mm

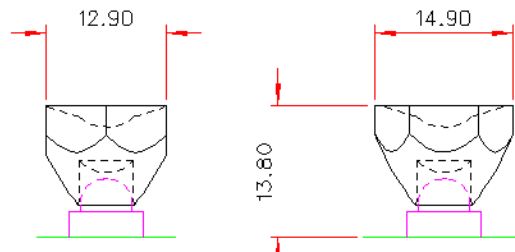
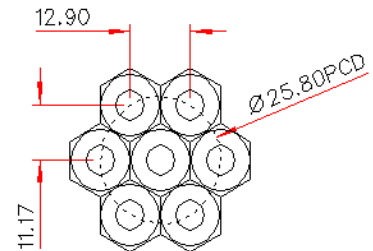
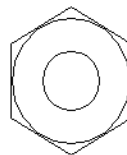

Polymer Optics “Modular LED Optics”® design, based on a hexagonal format, allows maximum packing density and assembly flexibility

Holder (Part No. 121) available for mounting optics onto LUXEON® I Star or LUXEON® Emitter PCB’s

Star Holder (Part No. 128) available for LUXEON® III Star formats only.

K2 Holder (Part No. 151) available for LUXEON® K2 LED range.

Due to continuous product improvement, POL reserve the right to change specifications without notice.